

Frame S1

LE4 204AD _

Technical description

Semi-recessed LED fitting for false ceilings. Body in die cast aluminium. Reflector in anodized aluminium with high luminous efficiency rotation on the vertical axis of 350 °, spot adjustability 45°.

This fitting is equipped with integrated LED modules.

Body in die-cast aluminium according to the regulations UNI 5076 EN - AB 46100. Optics in anodized aluminium.

LED light source CREE COB and colour temperature (3000K).

Very high coefficient of rendering >90CRI.

Supply

Remote driver included.

Input voltage 220-240 V AC/50-60Hz

Temperature -20° +40°

Life 30000h / 25°

Installation

Recessed / Semi recessed for ceiling.

Size (mm)

195 x 195 x 176

Color

White ☐ 1 Grey ☒ 2



IP20

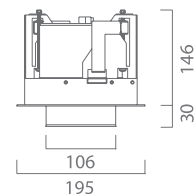

Code	Source	Power	Luminous Flux	Temperature	CRI	Beams	Color
LE4 204AD 1	COB CREE	28 W	1914 lm	3000 K	>90	60°	White
LE4 204AD 2	COB CREE	28 W	1914 lm	3000 K	>90	60°	Grey