

Frame S1

LE4 105A3 _

Technical description

Semi-recessed LED fitting for false ceilings. Body in die cast aluminium. Reflector in anodized aluminium with high luminous efficiency rotation on the vertical axis of 350 °, spot adjustability 45°.

This fitting is equipped with integrated LED modules.

Body in die-cast aluminium according to the regulations UNI 5076 EN - AB 46100. Optics in anodized aluminium.

LED light source CREE COB and colour temperature (2700K).

Very high coefficient of rendering >90CRI.

Supply

Remote driver included.

Input voltage 220-240 V AC/50-60Hz

Temperature -20° +40°

Life 30000h / 25°

Installation

Recessed / Semi recessed for ceiling.

Size (mm)

195 x 195 x 176

Color

White ☐ 1 Grey ☒ 2



IP20

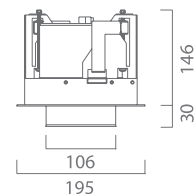

Code	Source	Power	Luminous Flux	Temperature	CRI	Beams	Color
LE4 105A3 1	COB CREE	35 W	2861 lm	2700 K	>90	15°	White
LE4 105A3 2	COB CREE	35 W	2861 lm	2700 K	>90	15°	Grey